

# Dreamline

WHEELCHAIR SEATING

CODES VISUAL DIRECTORY



# MODIFICATIONS TO FULL SEAT SYSTEM

## DARTEX SMOOTH ON CONTACT SURFACES

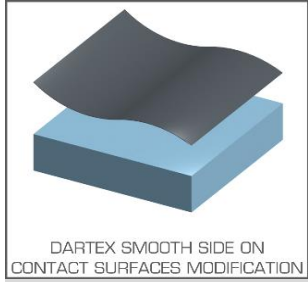

DMODCPU

## CUSTOM FABRIC ON CONTACT SURFACES

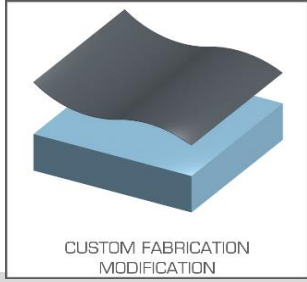

DMODCOF

## RED COLOUR ON NON-CONTACT SURFACES



DMODRED

## ORANGE COLOUR ON NON-CONTACT SURFACES



DMODORA

## GREEN COLOUR ON NON-CONTACT SURFACES



DMODGRE

## BLUE COLOUR ON NON-CONTACT SURFACES



DMODBLU

## PINK COLOUR ON NON-CONTACT SURFACES



DMODPIN

## PURPLE COLOUR ON NON-CONTACT SURFACES



DMODPUR



# CUSHIONS

## G3-POMMEL

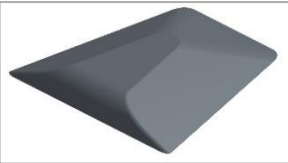

SML

DGCPOMSML

LGE

DGCPOMLGE

## DREAMLINE G3 LATERAL WEDGE

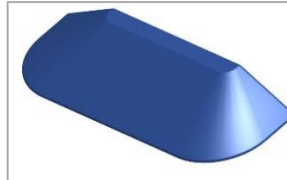

DGCPS

## G3 BASE ONLY

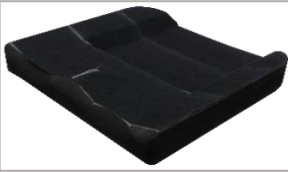

DGC1212B	DGC1214B	DGC1414B	DGC1416B
DGC1418B	DGC1616B	DGC1618B	DGC1620B
DGC1717B	DGC1816B	DGC1818B	DGC1820B
DGC1822B	DGC2018B	DGC2020B	DGCCUSTB
DGCCUSTLB			

## G3 COMFORT WRAP ONLY



DGC1212CW	DGC1214CW	DGC1414CW	DGC1416CW
DGC1418CW	DGC1616CW	DGC1618CW	DGC1620CW
DGC1717CW	DGC1816CW	DGC1818CW	DGC1820CW
DGC1822CW	DGC2018CW	DGC2020CW	DGCCUSTCW
DGCCUSTXLCW			

## STX-FOAM



DXCF1212	DXCF1214	DXCF1414	DXCF1416
DXCF1418	DXCF1616	DXCF1618	DXCF1620
DXCF1717	DXCF1816	DXCF1818	DXCF1820
DXCF1822	DXCF2018	DXCF2020	DXCFCUST
DXCFCUSTXL			

*Outer Cover only add "OC" to end of code*

*Inner Cover only add "IC" to end of code*

## STX-GEL



DXC1212	DXC1214	DXC1414	DXC1416
DXC1418	DXC1616	DXC1618	DXC1620
DXC1717	DXC1816	DXC1818	DXC1820
DXC1822	DXC2018	DXC2020	DXCCUST
DXCCUSTXL			

*Outer Cover only add "OC" to end of code*

*Inner Cover only add "IC" to end of code*

## STX BASE ONLY



DXC1212B	DXC1214B	DXC1414B	DXC1416B
DXC1418B	DXC1616B	DXC1618B	DXC1620B
DXC1717B	DXC1816B	DXC1818B	DXC1820B
DXC1822B	DXC2018B	DXC2020B	DXCCUSTB
DXCCUSTXLB			

# CUSHIONS

## STX THIGH WEDGE



DXCTW12	DXCTW14	DXCTW16	DXCTW17
DXCTW18	DXCTW20	DXCTWCUST	DXCTWCUSTXL

## STX LATERAL



### LEFT

DXCLATL12	DXCLATL14
DXCLATL16	DXCLATL17
DXCLATL18	DXCLATL20
DXCLATL22	DXCLATLCUST
DXCLATLCUSTXL	

### RIGHT

DXCLATR12	DXCLATR14
DXCLATR16	DXCLATR17
DXCLATR18	DXCLATR20
DXCLATR22	DXCLATRCUST
DXCLATRCUSTXL	

## STX LATERAL SEGMENT



DXCLAT3
DXCLAT4
DXCLAT6

## STX POMMEL



<b>LEFT</b>
DXCPOML4
DXCPOML6
<b>RIGHT</b>
DXCPOMR4
DXCPOMR6

## STX PRE-ISCHIAL WEDGE



DXCPIW12	DXCPIW14	DXCPIW16	DXCPIW17
DXCPIW18	DXCPIW20	DXCPIWCUST	DXCPIWCUSTXL

## STX PRE-ISCHIAL WEDGE



DXCPIS12	DXCPIS14	DXCPIS16	DXCPIS17
DXCPIS18	DXCPIS20	DXCPISCUST	DXCPISCUSTXL

## STX COMFORT WRAP



DGC1212CW	DGC1214CW	DGC1414CW	DGC1416CW
DGC1418CW	DGC1616CW	DGC1618CW	DGC1620CW
DGC1717CW	DGC1816CW	DGC1818CW	DGC1820CW
DGC1822CW	DGC2018CW	DGC2020CW	DGCCUSTCW
DGCCUSTXLCW			

# CUSHIONS

## GEL CLUSTER PK



DCG46

## SUNMATE CLUSTER PK



DCSFB46

## STD FOAM CLUSTER PK



DCRF46

## STX BAC PADS 10 KIT



DXCBACKIT

## PELVIC OBLIQUITY PADS - SET OF 4



DCOP8	DCOP10
DCOP12	DCOP14
DCOP16	DCOP18
DCOP20	DCOP22
DCOP24	DCOPCUST

## CUSHION GEL WRAP



DCGW0808	DCGW0810	DCGW1010	DCGW1012
DCGW1212	DCGW1214	DCGW1414	DCGW1416
DCGW1418	DCGW1616	DCGW1618	DCGW1620
DCGW1717	DCGW1816	DCGW1818	DCGW1820
DCGW2018	DCGW2020	DCGW2218	DCGW2220
DCGW2222	DCGW2420	DCGW2422	DCGW2424
DCGWCUST	DCGWCUSTXL		



# CUSHION MODIFICATIONS

## CUST LAT HEIGHT

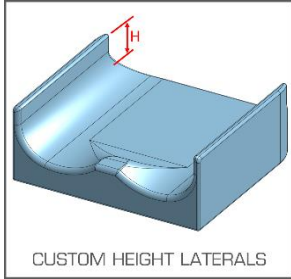

## CUST POM HEIGHT

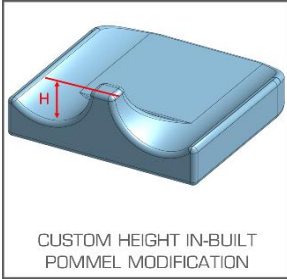

## CUSTOM O/A HEIGHT

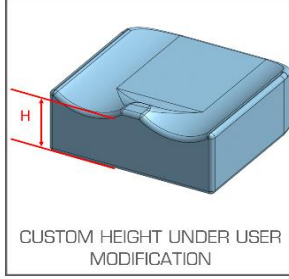

## REAR CORNER CUT

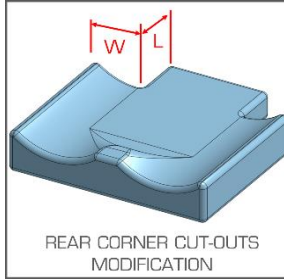

## RAMPING

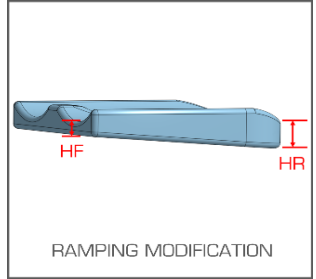

DXCMODCL

DXMODCP

DXCMODEH

DCMODCC

DCMODFR

## REMOVE LAT FRNT 1/2

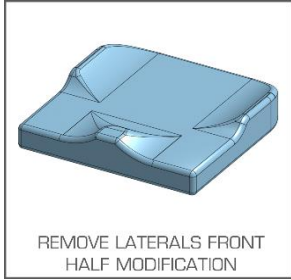

## REMOVE LAT REAR 1/2

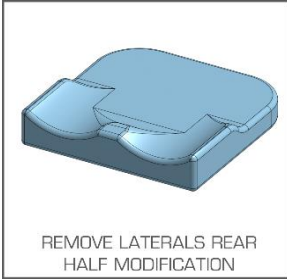

## REMOVE LAT

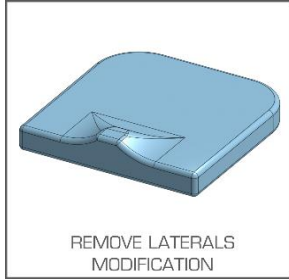

## REMOVE POM

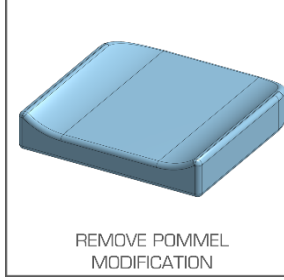

## SUPRACOR OVERLAY



DCMODRFL

DCMODCC

DCMODRL

DCMODRP

DCMODSBS1

## SUNMATE OVERLAY

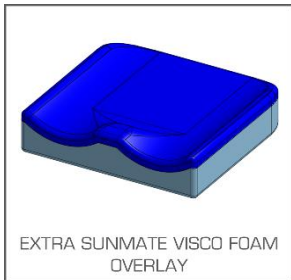

## 15mm ADD THICKNESS



## TAPERED SIDES

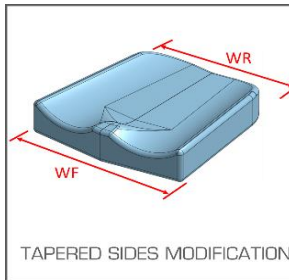

## DARTEX SMOOTH

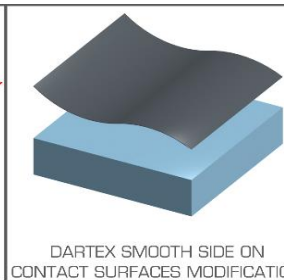

## CUSTOM FABRIC

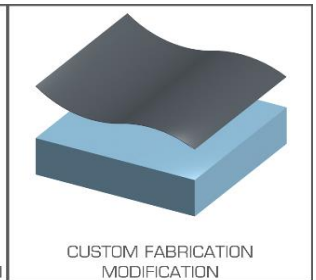

DCMODSFO

DCMODEF

DCMODTS

DCMODCPU

DCMODCF

## LEFT LEG DISCREPANCY CUT OUT

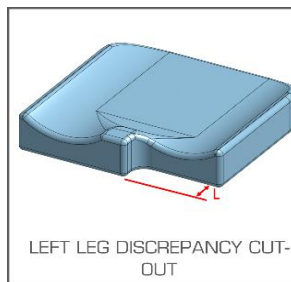

DCMODLLDL1

DCMODLLDL2

DCMODLLDL3

DCMODLLDL4

DCMODLLDL5

DCMODLLDL6

## RIGHT LEG DISCREPANCY CUT OUT

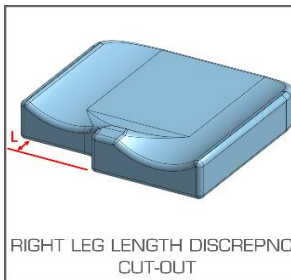

DCMODLLDR1

DCMODLLDR2

DCMODLLDR3

DCMODLLDR4

DCMODLLDR5

DCMODLLDR6

Modification to Outer Cover only add "OC" to end of code

Modification to Inner Cover only add "IC" to end of code

# SEAT BASES

## QUICK-RELEASE SEAT PAN



DSP1212	DSP1214	DSP1414	DSP1416
DSP1418	DSP1616	DSP1618	DSP1620
DSP1818	DSP1820	DSP2020	DSPCUST
DSPCUSTXL			

## Q/R SEAT PAN CLAMPS KIT



DSPCKIT

## SEAT PAN ATTACH. BRACKETS COMPLETE



DSPAH

## SEAT PAN FRONT BRACKETS



DSPAHF

## SEAT PAN REAR BRACKETS



DSPAHR

## SEAT PAN FRONT CLAMPS



DSPCF

## SEAT PAN REAR CLAMPS



DSPCR

## SEAT PAN FASTENERS



DSPFKIT

## CUSHION RIGID BASE



DCRB0808	DCRB0810	DCRB1010	DCRB1012
DCRB1212	DCRB1214	DCRB1414	DCRB1416
DCRB1418	DCRB1616	DCRB1618	DCRB1620
DCRB1816	DCRB1818	DCRB1820	DCRB2018
DCRB2020	DCRB2218	DCRB2220	DCRB2222
DCRB2420	DCRB2422	DCRB2424	DCRBCUST
DCRBCUSTXL			

## CUSHION RIGID LATERAL



DCRL08	DCRL10	DCRL12	DCRL14
DCRL16	DCRL17	DCRL18	DCRL20
DCRL22	DCRL24	DCRLCUST	DCRLCUSTXL



# SEAT BASE MODIFICATIONS

## LEFT LEG LENGTH DISCREPANCY CUT OUT

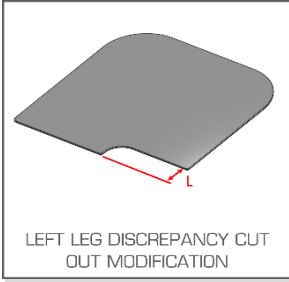

DSPMODLLDL1	DSPMODLLDL2	DSPMODLLDL3	DSPMODLLDL4
DSPMODLLDL5	DSPMODLLDL6		

## RIGHT LEG LENGTH DISCREPANCY CUT OUT

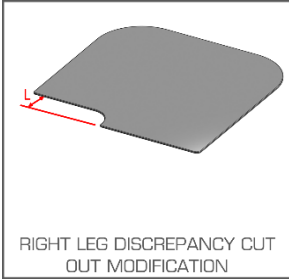

DSPMODLLDR1	DSPMODLLDR2	DSPMODLLDR3	DSPMODLLDR4
DSPMODLLDR5	DSPMODLLDR6		

## REAR CORNER CUT

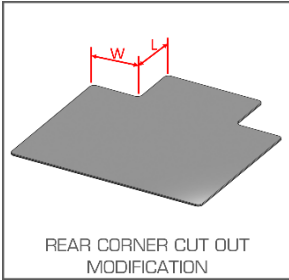

DSPMODCC
----------

# BACKRESTS

## PRO BACKREST - FIXED

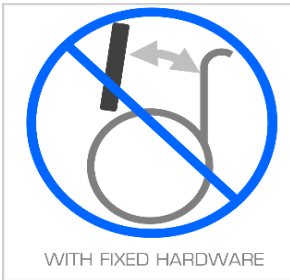

DPBF1206	DPBF1208	DPBF1210
DPBF1407	DPBF1409	DPBF1411
DPBF1413	DPBF1607	DPBF1609
DPBF1611	DPBF1613	DPBF1615
DPBF1807	DPBF1809	DPBF1811
DPBF1813	DPBF1815	DPBF2007
DPBF2009	DPBF2011	DPBF2013
DPBF2015	DPBFCUST	DPBFCUSTXL

## PRO BACKREST - QUICK RELEASE



DPB1206	DPB1208	DPB1210
DPB1407	DPB1409	DPB1411
DPB1413	DPB1607	DPB1609
DPB1611	DPB1613	DPB1615
DPB1807	DPB1809	DPB1811
DPB1813	DPB1815	DPB2007
DPB2009	DPB2011	DPB2013
DPB2015	DPBCUST	DPBCUSTXL

Outer Cover only add "OC" to end of code  
Inner Cover only add "IC" to end of code

Shell & Pad only add "SP" to end of code  
Foam & Cover only add "FC" to the end of code

## CONTOUR BACKREST - FIXED

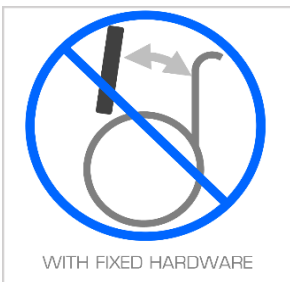

DCBF0810	DCBF0812	DCBF1012
DCBF1014	DCBF1214	DCBF1216
DCBF1218	DCBF1414	DCBF1416
DCBF1418	DCBF1420	DCBF1616
DCBF1618	DCBF1620	DCBF1622
DCBF1816	DCBF1818	DCBF1820
DCBF1822	DCBF2018	DCBF2020
DCBF2022	DCBFCUST	DCBFCUSTXL

## CONTOUR BACKREST - QUICK RELEASE



DCB0810	DCB0812	DCB1012
DCB1014	DCB1214	DCB1216
DCB1218	DCB1414	DCB1416
DCB1418	DCB1420	DCB1616
DCB1618	DCB1620	DCB1622
DCB1816	DCB1818	DCB1820
DCB1822	DCB2018	DCB2020
DCB2022	DCBCUST	DCBCUSTXL

Outer Cover only add "OC" to end of code  
Inner Cover only add "IC" to end of code

Shell & Pad only add "SP" to end of code  
Foam & Cover only add "FC" to the end of code

# BACKRESTS

## CONTOUR STX BACKREST - QUICK RELEASE



DREAMLINE CONTOUR BACKREST



WITH QUICK-RELEASE HARDWARE

DCXB0810	DCXB0812	DCXB1012
DCXB1014	DCXB1214	DCXB1216
DCXB1218	DCXB1414	DCXB1416
DCXB1418	DCXB1420	DCXB1616
DCXB1618	DCXB1620	DCXB1622
DCXB1816	DCXB1818	DCXB1820
DCXB1822	DCXB2018	DCXB2020
DCXB2022	DCXBCUST	DCXBCUSTXL

*Outer Cover only add "OC" to end of code*  
*Inner Cover only add "IC" to end of code*  
*Shell & Pad only add "SP" to end of code*  
*Foam & Cover only add "FC" to the end of code*



DREAMLINE STX SUNMATE CLUSTER PACK ACCESSORY

## SUPPORT BACKREST - FIXED



DREAMLINE SUPPORT BACKREST

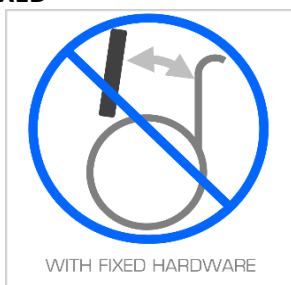

WITH FIXED HARDWARE

DSBF0810	DSBF0812	DSBF1012
DSBF1014	DSBF1214	DSBF1216
DSBF1218	DSBF1414	DSBF1416
DSBF1418	DSBF1420	DSBF1616
DSBF1618	DSBF1620	DSBF1622
DSBF1816	DSBF1818	DSBF1820
DSBF1822	DSBF2018	DSBF2020
DSBF2022	DSBFCUST	DSBFCUSTXL

## SUPPORT BACKREST - QUICK RELEASE



DREAMLINE SUPPORT BACKREST



WITH QUICK-RELEASE HARDWARE

DSB0810	DSB0812	DSB1012
DSB1014	DSB1214	DSB1216
DSB1218	DSB1414	DSB1416
DSB1418	DSB1420	DSB1616
DSB1618	DSB1620	DSB1622
DSB1816	DSB1818	DSB1820
DSB1822	DSB2018	DSB2020
DSB2022	DSBCUST	DSBCUSTXL

*Outer Cover only add "OC" to end of code*  
*Inner Cover only add "IC" to end of code*

*Shell & Pad only add "SP" to end of code*  
*Foam & Cover only add "FC" to the end of code*

## SUPPORT BACKREST WITH BAC - FIXED



DREAMLINE SUPPORT BACKREST WITH BAC SYSTEM INSIDE

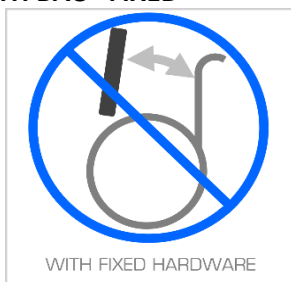

WITH FIXED HARDWARE

DSBACF0810	DSBACF0812	DSBACF1012
DSBACF1014	DSBACF1214	DSBACF1216
DSBACF1218	DSBACF1414	DSBACF1416
DSBACF1418	DSBACF1420	DSBACF1616
DSBACF1618	DSBACF1620	DSBACF1622
DSBACF1816	DSBACF1818	DSBACF1820
DSBACF1822	DSBACF2018	DSBACF2020
DSBACF2022	DSBACFCUST	DSBACFCUSTXL

# BACKRESTS

## SUPPORT BACKREST WITH BAC - QUICK RELEASE



DSBAC0810	DSBAC0812	DSBAC1012
DSBAC1014	DSBAC1214	DSBAC1216
DSBAC1218	DSBAC1414	DSBAC1416
DSBAC1418	DSBAC1420	DSBAC1616
DSBAC1618	DSBAC1620	DSBAC1622
DSBAC1816	DSBAC1818	DSBAC1820
DSBAC1822	DSBAC2018	DSBAC2020
DSBAC2022	DSBACCUST	DSBACCUSTXL

Outer Cover only add "OC" to end of code  
Inner Cover only add "IC" to end of code

Shell & Pad only add "SP" to end of code  
Foam & Cover only add "FC" to the end of code

## SUPPORT BACKREST WITH BAC & EXPANDER COVER - QUICK RELEASE

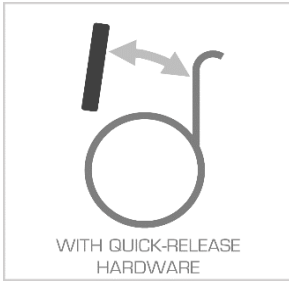

DSBACEC0810	DSBACEC0812	DSBACEC1012
DSBACEC1014	DSBACEC1214	DSBACEC1216
DSBACEC1218	DSBACEC1414	DSBACEC1416
DSBACEC1418	DSBACEC1420	DSBACEC1616
DSBACEC1618	DSBACEC1620	DSBACEC1622
DSBACEC1816	DSBACEC1818	DSBACEC1820
DSBACEC1822	DSBACEC2018	DSBACEC2020
DSBACEC2022	DSBACECCUST	DSBACECCUSTXL



Outer Cover only add "OC" to end of code  
Inner Cover only add "IC" to end of code

## S3 BACKREST - FIXED

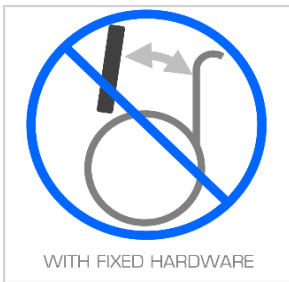

D3BF0810	D3BF0812	D3BF1012
D3BF1014	D3BF1214	D3BF1216
D3BF1218	D3BF1414	D3BF1416
D3BF1418	D3BF1420	D3BF1616
D3BF1618	D3BF1620	D3BF1622
D3BF1816	D3BF1818	D3BF1820
D3BF1822	D3BF2018	D3BF2020
D3BF2022	D3BFCUST	D3BFCUSTXL

## S3 BACKREST - QUICK RELEASE

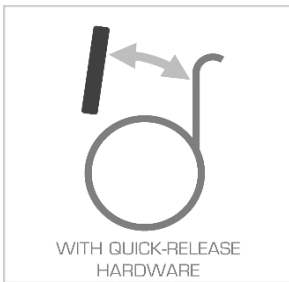

D3B0810	D3B0812	D3B1012
D3B1014	D3B1214	D3B1216
D3B1218	D3B1414	D3B1416
D3B1418	D3B1420	D3B1616
D3B1618	D3B1620	D3B1622
D3B1816	D3B1818	D3B1820
D3B1822	D3B2018	D3B2020
D3B2022	D3BCUST	D3BCUSTXL

Outer Cover only add "OC" to end of code  
Inner Cover only add "IC" to end of code

Shell & Pad only add "SP" to end of code  
Foam & Cover only add "FC" to the end of code

# BACKRESTS

## S3 BACKREST WITH BAC - FIXED



D3BACF0810	D3BACF0812	D3BACF1012
D3BACF1014	D3BACF1214	D3BACF1216
D3BACF1218	D3BACF1414	D3BACF1416
D3BACF1418	D3BACF1420	D3BACF1616
D3BACF1618	D3BACF1620	D3BACF1622
D3BACF1816	D3BACF1818	D3BACF1820
D3BACF1822	D3BACF2018	D3BACF2020
D3BACF2022	D3BACFCUST	D3BACFCUSTXL

## S3 BACKREST WITH BAC - QUICK RELEASE



D3BAC0810	D3BAC0812	D3BAC1012
D3BAC1014	D3BAC1214	D3BAC1216
D3BAC1218	D3BAC1414	D3BAC1416
D3BAC1418	D3BAC1420	D3BAC1616
D3BAC1618	D3BAC1620	D3BAC1622
D3BAC1816	D3BAC1818	D3BAC1820
D3BAC1822	D3BAC2018	D3BAC2020
D3BAC2022	D3BACCUST	D3BACCUSTXL

Outer Cover only add "OC" to end of code  
Inner Cover only add "IC" to end of code

Shell & Pad only add "SP" to end of code  
Foam & Cover only add "FC" to the end of code

## S3 BACKREST WITH BAC & EXPANDER COVER - QUICK RELEASE



D3BACEC0810	D3BACEC0812	D3BACEC1012
D3BACEC1014	D3BACEC1214	D3BACEC1216
D3BACEC1218	D3BACEC1414	D3BACEC1416
D3BACEC1418	D3BACEC1420	D3BACEC1616
D3BACEC1618	D3BACEC1620	D3BACEC1622
D3BACEC1816	D3BACEC1818	D3BACEC1820
D3BACEC1822	D3BACEC2018	D3BACEC2020
D3BACEC2022	D3BACECCUST	D3BACECCUSTXL

Outer Cover only add "OC" to end of code  
Inner Cover only add "IC" to end of code



## STX BACKREST FIXED



DXBF0810	DXBF0812	DXBF1012
DXBF1014	DXBF1214	DXBF1216
DXBF1218	DXBF1414	DXBF1416
DXBF1418	DXBF1420	DXBF1616
DXBF1618	DXBF1620	DXBF1622
DXBF1816	DXBF1818	DXBF1820
DXBF1822	DXBF2018	DXBF2020
DXBF2022	DXBFCUST	DXBFCUSTXL

# BACKRESTS

## STX BACKREST - QUICK RELEASE



DXB0810	DXB0812	DXB1012
DXB1014	DXB1214	DXB1216
DXB1218	DXB1414	DXB1416
DXB1418	DXB1420	DXB1616
DXB1618	DXB1620	DXB1622
DXB1816	DXB1818	DXB1820
DXB1822	DXB2018	DXB2020
DXB2022	DXBCUST	DXBCUSTXL

Outer Cover only add "OC" to end of code  
Inner Cover only add "IC" to end of code

Shell & Pad only add "SP" to end of code  
Foam & Cover only add "FC" to the end of code

## STX BACKREST WITH EXPANDER COVER - QUICK RELEASE



DXBEC0810	DXBEC0812	DXBEC1012
DXBEC1014	DXBEC1214	DXBEC1216
DXBEC1218	DXBEC1414	DXBEC1416
DXBEC1418	DXBEC1420	DXBEC1616
DXBEC1618	DXBEC1620	DXBEC1622
DXBEC1816	DXBEC1818	DXBEC1820
DXBEC1822	DXBEC2018	DXBEC2020
DXBEC2022	DXBECCUST	DXBECCUSTXL

Outer Cover only add "OC" to end of code  
Inner Cover only add "IC" to end of code



## BACKREST EXPANDER OUTER COVER ONLY



DBEC0810OC	DBEC0812OC	DBEC1012OC	DBEC1014OC
DBEC1214OC	DBEC1216OC	DBEC1218OC	DBEC1414OC
DBEC1416OC	DBEC1418OC	DBEC1420OC	DBEC1616OC
DBEC1618OC	DBEC1620OC	DBEC1622OC	DBEC1816OC
DBEC1818OC	DBEC1820OC	DBEC1822OC	DBEC2018OC
DBEC2020OC	DBEC2022OC	DBECCUSTOC	DBECCUSTXLOC

## BACKREST EXPANDER INNER COVER ONLY



DBEC0810IC	DBEC0812IC	DBEC1012IC	DBEC1014IC
DBEC1214IC	DBEC1216IC	DBEC1218IC	DBEC1414IC
DBEC1416IC	DBEC1418IC	DBEC1420IC	DBEC1616IC
DBEC1618IC	DBEC1620IC	DBEC1622IC	DBEC1816IC
DBEC1818IC	DBEC1820IC	DBEC1822IC	DBEC2018IC
DBEC2020IC	DBEC2022IC	DBECCUSTIC	DBECCUSTXLIC



# BACKRESTS

## DREAMLINE SUPPORT BACKREST GROWTH KIT - SPARE PART



DSBGKC1218	DSBGKC1420	DSBGKC1622	DSBGKC1822
DSBGKC2022	DSBGKC1222	DSBGKC1424	DSBGKC1626
DSBGKC1826	DSBGKC2026		

## DREAMLINE SUPPORT BACKREST UPGRADE TO INCLUDE GROWTH KIT

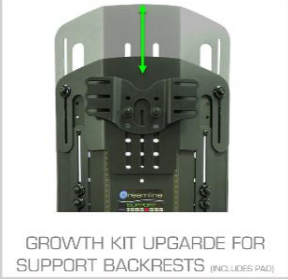

DSBGKU1218	DSBGKU1420	DSBGKU1622	DSBGKU1822
DSBGKU2022	DSBGKU1222	DSBGKU1424	DSBGKU1626
DSBGKU1826	DSBGKU2026		

### BACKREST FIXED BKTS



DBU2FA

### BACKREST COMPACT FIXED BKTS



DBCMPFA

### COMPACT Q/R CLAMPS



DBU2CPQRCLAMPKIT

### STD Q/R CLAMPS



DBU2QRCLAMPKIT

### 4-PT CLAMP KIT



DBU2QRCLAMPKIT4PT

### BACKREST Q/R BKTS KIT



DBU2COM2P

### COMPACT BACKREST Q/R BKTS



DBU2CPCOM2P

### 4-PT BACKREST UPGRADE KIT



DBU2QR4PTKIT

### 90° BACKREST L-BKTS



DBU2QRCOM2P90

# BACKRESTS

## BACKREST L-BKT (2 PIN)



DBU2LBKTDUAL

## BACKREST L-BKT (1 PIN)



DBU2LBKTSING

## 4-PT BACKREST BKTS



DBU2QRCOM4P

## BACKREST WIDTH REDUCTION KIT



BACKREST WIDTH REDUCTION  
KIT UPGRADE (OFF-SET HARDWARE)

DBWRK

## BACKREST LOCK PINS



DREAMLINE QUICK-RELEASE  
LOCK PIN ACCESSORY

DBU2LA

## LUMBAR LAT WDG KIT



EXTRA LUMBAR AND LATERAL  
WEDGE KIT ACCESSORY

DBLMLTKIT

## LUMBAR PAD



EXTRA LUMBAR PAD  
ACCESSORY

DBLP

## LATERAL WEDGE



EXTRA LATERAL WEDGE  
ACCESSORY

DBLW

## LEVO MOUNT



DREAMLINE ATTACHMENT KIT  
FOR LEVO WHEELCHAIR

DBMLEVO

## SUNMATE CLUST PK



DREAMLINE STX SUNMATE  
CLUSTER PACK ACCESSORY

DCSFB46

## MODESTY FLAP



MODESTY FLAP FOR DREAMLINE  
BACKREST

DBMP12

DBMP16

DBMP20

DBMP14

DBMP18

DBMPCUST

# BACKREST MODIFICATIONS

## EXTRA THICKNESS

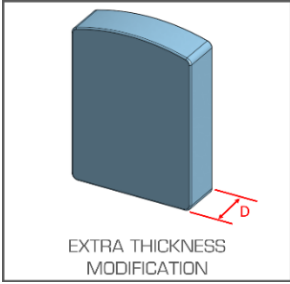

DBMODEF

## T-SHAPED MOD

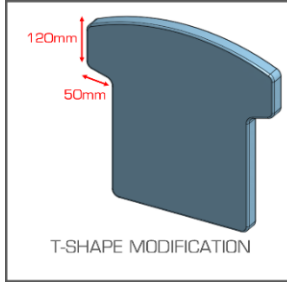

DBMODT

## SUPRACOR OVERLAY



DBMODSBS1

## GEL INSERT FOR SPINE

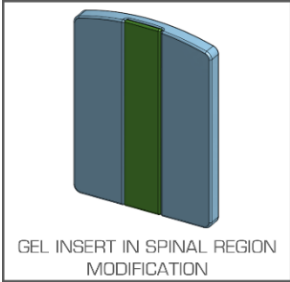

DBMODGSI

## DARTEX SMOOTH

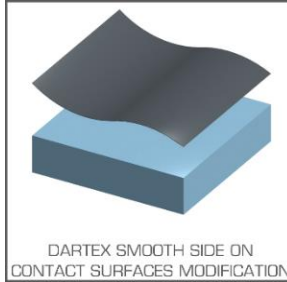

DBMODCPU

## CUSTOM FABRIC

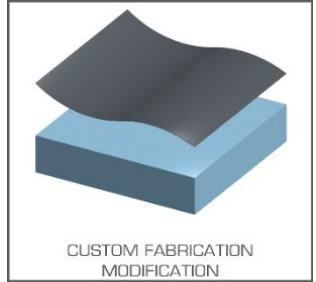

DBMODCF

# BAC POSITIONING SYSTEM

## BAC POSITIONING SYSTEM (2 LAYERS)



DBACSB0810	DBACSB0812	DBACSB1012	DBACSB1014
DBACSB1214	DBACSB1216	DBACSB1218	DBACSB1414
DBACSB1416	DBACSB1418	DBACSB1420	DBACSB1616
DBACSB1618	DBACSB1620	DBACSB1622	DBACSB1816
DBACSB1818	DBACSB1820	DBACSB1822	DBACSB2018
DBACSB2020	DBACSB2022	DBACSBUCUST	DBACSBUCUSTXL

## BAC GROWTH KIT UPGRADE



DBACGK08	DBACGK10	DBACGK12	DBACGK14
DBACGK16	DBACGK18	DBACGK20	DBACGKUCUST
DBACGKUCUSTXL			

## BAC MAX POSITIOING SYSTEM (4 LAYERS)



DBACMXSB0810	DBACMXSB0812	DBACMXSB1012	DBACMXSB1014
DBACMXSB1214	DBACMXSB1216	DBACMXSB1218	DBACMXSB1414
DBACMXSB1416	DBACMXSB1418	DBACMXSB1420	DBACMXSB1616
DBACMXSB1618	DBACMXSB1620	DBACMXSB1622	DBACMXSB1816
DBACMXSB1818	DBACMXSB1820	DBACMXSB1822	DBACMXSB2018
DBACMXSB2020	DBACMXSB2022	DBACMXSBCUST	DBACMXSBCUSTXL

## BAC MAX GROWTH KIT UPGRADE



DBACMAXGK8	DBACMAXGK10	DBACMAXGK12	DBACMAXGK14
DBACMAXGK16	DBACMAXGK18	DBACMAXGK20	DBACMAXGKUCUST
DBACMAXGKUCUSTXL			

## BAC PADS 10 PK



DBACPADS10

## BAC T-SHAPE MOD

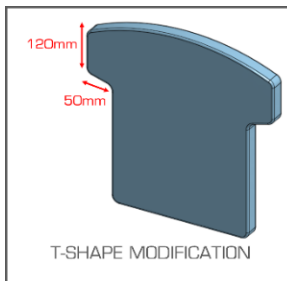

DBACMODT

# CORPUS BACKREST SQUABS

## SUPPORT BACKREST FOR CORPUS

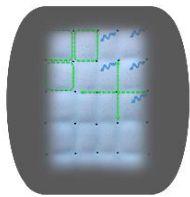

DREAMLINE SUPPORT SQUAB  
FOR CORPUS BACKREST

CDSB1420FC	CDSB1425FC	CDSB1428FC	CDSB1620FC
CDSB1625FC	CDSB1628FC	CDSB1820FC	CDSB1825FC
CDSB1828FC	CDSB2020FC	CDSB2025FC	CDSB2028FC
CDSB2220FC	CDSB2225FC	CDSB2228FC	

*Replace "FC" with "OC" for spare outer cover*

## SUPPORT BACKREST WITH BAC FOR CORPUS

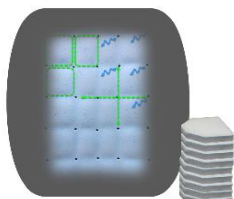

DREAMLINE SUPPORT SQUAB  
WITH BAC FOR CORPUS BACKREST

CDSBAC1420FC	CDSBAC1425FC	CDSBAC1428FC	CDSBAC1620FC
CDSBAC1625FC	CDSBAC1628FC	CDSBAC1820FC	CDSBAC1825FC
CDSBAC1828FC	CDSBAC2020FC	CDSBAC2025FC	CDSBAC2028FC
CDSBAC2220FC	CDSBAC2225FC	CDSBAC2228FC	

*Replace "FC" with "OC" for spare outer cover*

## S3 BACKREST FOR CORPUS



DREAMLINE S3 SQUAB FOR  
CORPUS BACKREST

CD3B1420FC	CD3B1425FC	CD3B1428FC	CD3B1620FC
CD3B1625FC	CD3B1628FC	CD3B1820FC	CD3B1825FC
CD3B1828FC	CD3B2020FC	CD3B2025FC	CD3B2028FC
CD3B2220FC	CD3B2225FC	CD3B2228FC	

*Replace "FC" with "OC" for spare outer cover*

## S3 BACKREST WITH BAC FOR CORPUS



DREAMLINE S3 SQUAB WITH  
BAC FOR CORPUS BACKREST

CD3BAC1420FC	CD3BAC1425FC	CD3BAC1428FC	CD3BAC1620FC
CD3BAC1625FC	CD3BAC1628FC	CD3BAC1820FC	CD3BAC1825FC
CD3BAC1828FC	CD3BAC2020FC	CD3BAC2025FC	CD3BAC2028FC
CD3BAC2220FC	CD3BAC2225FC	CD3BAC2228FC	

*Replace "FC" with "OC" for spare outer cover*

## STX BACKREST FOR CORPUS



DREAMLINE STX BACKREST  
SQUAB FOR CORPUS

CDXB1420FC	CDXB1425FC	CDXB1428FC	CDXB1620FC
CDXB1625FC	CDXB1628FC	CDXB1820FC	CDXB1825FC
CDXB1828FC	CDXB2020FC	CDXB2025FC	CDXB2028FC
CDXB2220FC	CDXB2225FC	CDXB2228FC	

*Replace "FC" with "OC" for spare outer cover*

# ABDUCTOR POMMEL

## SWING DOWN POMMEL WITH STD PAD



DPSDSML
DPSDMED
DPSDLGE
DPSDCUST

## SWING DOWN POMMEL WITH WATERFALL PAD



DPSDWSML
DPSDWMED
DPSDWLGE
DPSDWCUST

## SWING DOWN POMMEL BKT ONLY



DPSD
------

## SWING DOWN POMMEL STD PAD ONLY



DPPPSML
DPPPMED
DPPPLGE
DPPPCUSTOM

## SWING DOWN POMMEL WATERFALL PAD ONLY



DPPWPSML
DPPWPMED
DPPWPLGE
DPPWPCUST

## SWING DOWN POM BKT PROTECTOR SLEEVE

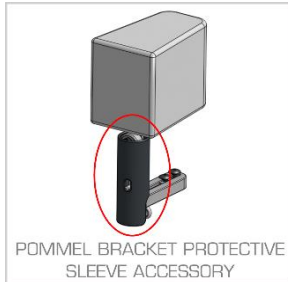

DPSDPS
--------

## POMMEL PADS SPARE OUTER COVER



STANDARD PAD OUTER COVER			
DPPSMLOC	DPPMEDOC	DPPLGEOC	DPPCUSTOC

WATERFALL PAD OUTER COVER			
DPPWSMLOC	DPPWMEDOC	DPPWLGEOC	DPPWCUSTOC

## POMMEL GEL OVERLAY

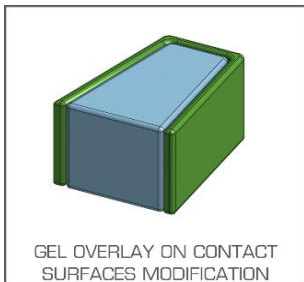

DPPMODGO
----------

## POMMEL DARTEX SMOOTH

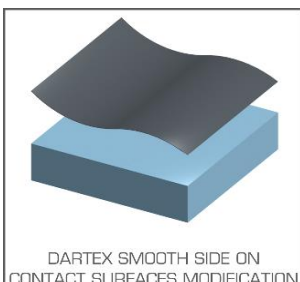

DPPMODCPU
-----------

## POM CUST FABRIC

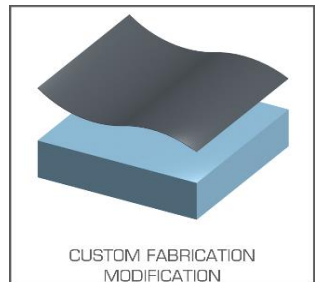

DPPMODCF
----------



# HIP GUIDES

## SWING DOWN HIP GUIDE



DSDHG10
DSDHG12
DSDHG14
DSDHG16
DSDHG18
DSDHGCUST

## SWING DOWN PIVOT HIP GUIDES



DSDHGP10
DSDHGP12
DSDHGP14
DSDHGP16
DSDHGP18
DSDHGPCUST

## HIP GUIDE PAD ONLY



DHGP10
DHGP12
DHGP14
DHGP16
DHGP18
DHGPCUST

## SWING DOWN HIP GUIDE BKT ONLY



DHGSD
-------

## SWING DOWN PIVOT HIP GUIDE BKT ONLY



DHGSDP
--------

## DROP-IN HIP BKT ONLY



DHGDIB
--------

## DROP IN HIP GUIDE MT



DHGDIM
--------

## HIP GUIDE SPACER



DHGSPACER
-----------

## HIP GUIDE SPARE OUTER COVER



DHGP10OC
DHGP12OC
DHGP14OC
DHGP16OC
DHGP18OC
DHGPCUSTOC

## HIP GUIDE GEL OVERLAY

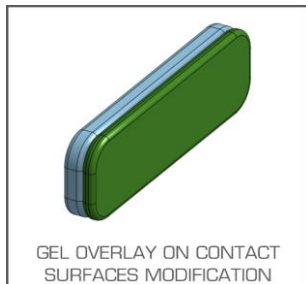

DHGMODGO
----------

## HIP GUIDE DARTEX SMOOTH COV.

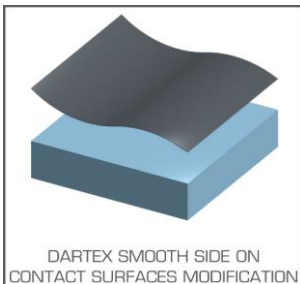

DHGMODCPU
-----------

## HIP GUIDE CUST FABRIC

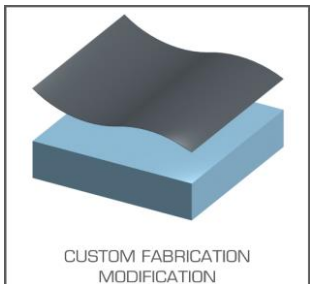

DHGMODCF
----------

# ARMRESTS

## ARMREST PAD & STEM (SWING DOWN)



DAR10
DAR12
DAR14
DAR16
DAR18
DARCUST

ARMREST PAD WITH VERTICAL STEM (ATTACHES TO SWING DOWN ATTACHMENT BRACKET)

## ARMREST PAD & STEM (DROP IN)



DARDI10
DARDI12
DARDI14
DARDI16
DARDI18
DARDICUST

DROP-IN ARMREST (ATTACHES TO DROP-IN HIP GUIDE ATTACHMENT BRACKET)

## ARMREST PAD ONLY



DARP10
DARP12
DARP14
DARP16
DARP18
DARPCUST

ARMREST PAD ONLY

## ARMREST SPARE OUTER COVER

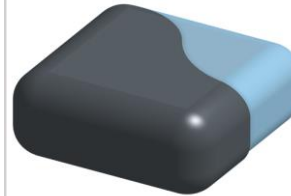

DARP10OC
DARP12OC
DARP14OC
DARP16OC
DARP18OC
DARPCUSTOC

SPARE OUTER COVER

## ARMREST GEL OVERLAY



GEL OVERLAY ON CONTACT SURFACES MODIFICATION

DARMODGO

## ARMREST DARTEX SMOOTH

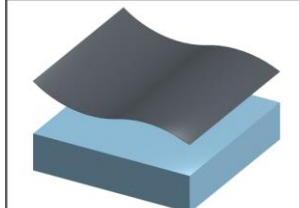

DARTEX SMOOTH SIDE ON CONTACT SURFACES MODIFICATION

DARMODCPU

## ARMREST CUST FABRIC

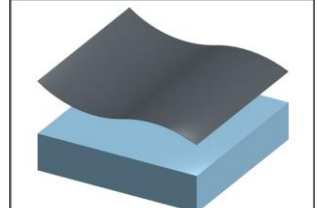

CUSTOM FABRICATION MODIFICATION

DARMODCF

## ARMREST DROP IN BKT



ARMREST DROP IN BRACKET ONLY

DARDIB

## ARMREST SWING DOWN BKT



ARMREST SWING DOWN BRACKET ONLY

DSDAR

## ELBOW BLOCK



ARMREST ELBOW BLOCK ACCESSORY

DELBBLKSML

DELBBLKMED

DELBBLKLGE

## SIDE ARM BLOCK



ARMREST FOREARM BLOCK ACCESSORY

DARMBLKSML
DARMBLKMED
DARMBLKLGE
DARMBLKCUST

# THORACIC LATERALS

## FIXED STRAIGHT LATERAL

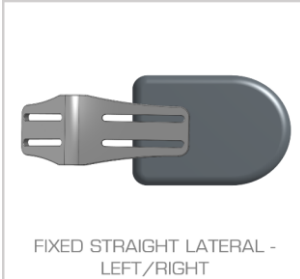

DFLSXSM
DFLSSML
DFLSMED
DFLSLGE

## FIXED TEARDROP LATERAL

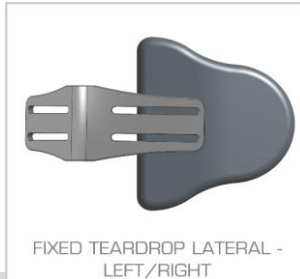

DFLTSM
DFLTMED
DFLTGE

## FIXED ADJUSTABLE STRAIGHT LATERAL



DFLASXSM
DFLASSML
DFLASMED
DFLASLGE

## FIXED ADJUSTABLE TEARDROP LATERAL



DFLATSM
DFLATMED
DFLATGE

## SWING AWAY STRAIGHT LATERAL

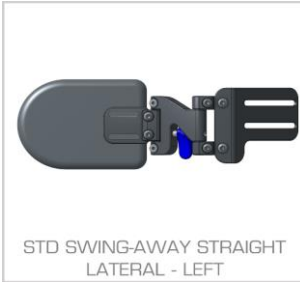

LEFT
DSALLSXSM
DSALLSSML
DSALLSMED
DSALLSLGE
RIGHT
DSALRSXSM
DSALRSSML
DSALRSMED
DSALRSLGE

## SWING AWAY CURVED LATERAL

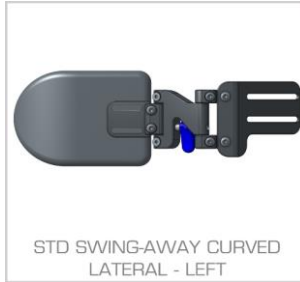

LEFT
DSALLCXSM
DSALLCSML
DSALLCMED
DSALLCLGE
RIGHT
DSALRCXSM
DSALRCSML
DSALRCMED
DSALRCLGE

## SWING AWAY ANTERIOR LATERAL

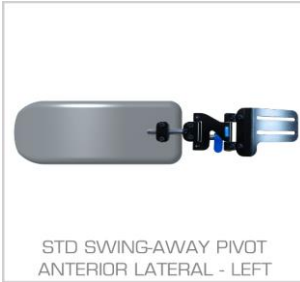

LEFT
DSALLAXSM
DSALLASML
DSALLAMED
DSALLALGE
RIGHT
DSALRAXSM
DSALRASML
DSALRAMED
DSALRALGE

## SWING AWAY TEARDROP LATERAL

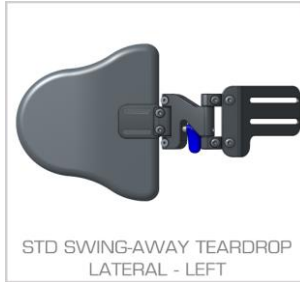

LEFT
DSALLTSM
DSALLTMED
DSALLTLGE
RIGHT
DSALRTSM
DSALRTMED
DSALRTLGE

## LO RISER SWING AWAY STRAIGHT LATERAL



LEFT
DSALLRLSXSM
DSALLRLSSML
DSALLRLSMED
DSALLRLSLGE
RIGHT
DSALLRRSXSM
DSALLRRSSML
DSALLRRSMED
DSALLRRSLGE

## LO RISER SWING AWAY CURVED LATERAL

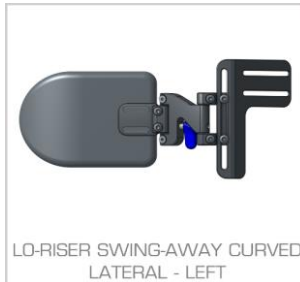

LEFT
DSALLRLCXSM
DSALLRLCSML
DSALLRLCMED
DSALLRLCLGE
RIGHT
DSALLRRCXSM
DSALLRRCSM
DSALLRRCMED
DSALLRRCCLGE

# THORACIC LATERALS

## LO RISER SWING AWAY ANTERIOR LATERAL

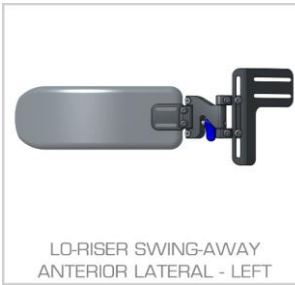

LEFT
DSALLRLAXSML
DSALLRLASML
DSALLRLAMED
DSALLRLALGE
RIGHT
DSALLRRAXSML
DSALLRRASML
DSALLRRAMED
DSALLRRALGE

## LO RISER SWING AWAY TERADROP LATERAL



LEFT
DSALLRLTSML
DSALLRLTMED
DSALLRLTLGE
RIGHT
DSALLRRTSML
DSALLRRTMED
DSALLRRTLGE

## SWING AWAY PIVOT STRAIGHT LATERAL



LEFT
DSALPLSXSM
DSALPLSSML
DSALPLSMED
DSALPLSLGE
RIGHT
DSALPRXSML
DSALPRSSML
DSALPRSMED
DSALPRSLGE

## SWING AWAY PIVOT CURVED LATERAL



LEFT
DSALPLCXSM
DSALPLCSML
DSALPLCMED
DSALPLCLGE
RIGHT
DSALPRCXSM
DSALPRCSML
DSALPRCMED
DSALPRCLGE

## SWING AWAY PIVOT ANTERIOR LATERAL



LEFT
DSALPLAXSM
DSALPLASML
DSALPLAMED
DSALPLALGE
RIGHT
DSALPRAXSM
DSALPRASML
DSALPRAMED
DSALPRALGE

## SWING AWAY PIVOT TEARDROP LATERAL



LEFT
DSALPLTSML
DSALPLTMED
DSALPLTLGE
RIGHT
DSALPRTSML
DSALPRTMED
DSALPRTLGE

## LO RISER SWING AWAY PIVOT STRAIGHT LAT



LEFT
DSALLRPLSXSM
DSALLRPLSSML
DSALLRPLSMED
DSALLRPLSLGE
RIGHT
DSALLRPRXSML
DSALLRPRSSML
DSALLRPRSMED
DSALLRPRSLGE

## LO RISER SWING AWAY PIVOT CURVED LAT



LEFT
DSALLRPLCXSM
DSALLRPLCSML
DSALLRPLCMED
DSALLRPLCLGE
RIGHT
DSALLRPRCXSM
DSALLRPRCSML
DSALLRPRCMED
DSALLRPRCLGE

# THORACIC LATERALS

## LO RISER SWING AWAY PIVOT ANTERIOR LAT



LEFT
DSALLRPLAXSML
DSALLRPLASML
DSALLRPLAMED
DSALLRPLALGE
RIGHT
DSALLRPRAXSML
DSALLRPRASML
DSALLRPRAMED
DSALLRPRALGE

## LO RISER SWING AWAY PIVOT TEARDROP LAT



LEFT
DSALLRPLTSML
DSALLRPLTMED
DSALLRPLTLGE
RIGHT
DSALLRPRTSML
DSALLRPRTMED
DSALLRPRTLGE

## LO RISER SWING AWAY KIDS STRAIGHT LAT

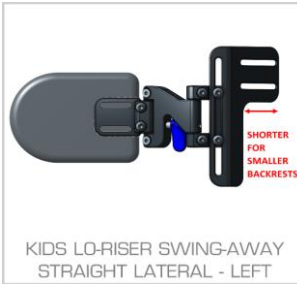

LEFT
DSALLRKLXSML
DSALLRKLSSML
DSALLRKLSMED
DSALLRKLGLGE
RIGHT
DSALLRKRSXSM
DSALLRKRSSML
DSALLRKRSMED
DSALLRKRSGLGE

## LO RISER SWING AWAY KIDS CURVED LAT

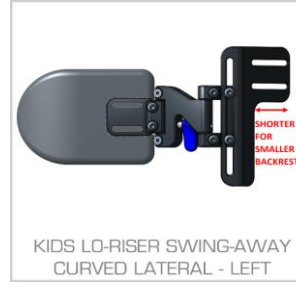

LEFT
DSALLRKLCXSML
DSALLRKLCSML
DSALLRKLCMED
DSALLRKLCLGE
RIGHT
DSALLRKRCXSML
DSALLRKRCXSM
DSALLRKRCMED
DSALLRKRCGLGE

## LO RISER SWING AWAY KIDS ANTERIOR LAT



LEFT
DSALLRKLAXSML
DSALLRKLASML
DSALLRKLAMED
DSALLRKLALGE
RIGHT
DSALLRKRXSML
DSALLRKRASML
DSALLRKRAMED
DSALLRKRALGE

## LO RISER SWING AWAY KIDS TEARDROP LAT



LEFT
DSALLRKLTSML
DSALLRKLTMED
DSALLRKLTLGE
RIGHT
DSALLRKRTSML
DSALLRKRTMED
DSALLRKRTLGE

## LO RISER S/A PIVOT KIDS STRAIGHT LAT

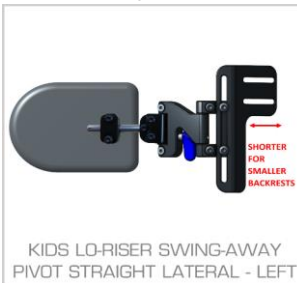

LEFT
DSALLRPKLSXSML
DSALLRPKLSSML
DSALLRPKLSMED
DSALLRPKLSLGE
RIGHT
DSALLRPKRSXSML
DSALLRPKRSSML
DSALLRPKRSMED
DSALLRPKRSLGE

## LO RISER S/A PIVOT KIDS CURVED LAT

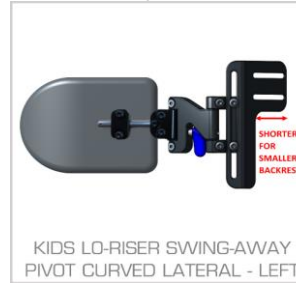

LEFT
DSALLRPKLCXSML
DSALLRPKLCXSM
DSALLRPKLCMED
DSALLRPKLCGLGE
RIGHT
DSALLRPKRCXSML
DSALLRPKRCSML
DSALLRPKRCMED
DSALLRPKRCLGE

# THORACIC LATERALS

## LO RISER S/A PIVOT KIDS ANTERIOR LAT

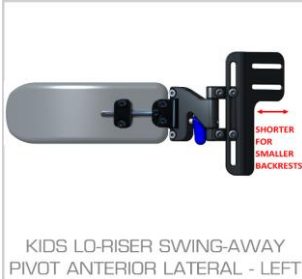

KIDS LO-RISER SWING-AWAY PIVOT ANTERIOR LATERAL - LEFT

LEFT
DSALLRPKLAXSML
DSALLRPKLASML
DSALLRPKLAMED
DSALLRPKLALGE
RIGHT
DSALLRPKRAXSML
DSALLRPKRASML
DSALLRPKRAMED
DSALLRPKRALGE

## LO RISER S/A PIVOT KIDS TEARDROP LAT

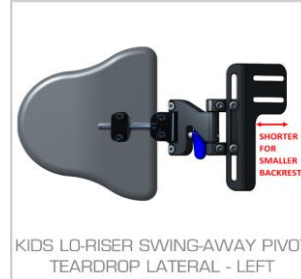

KIDS LO-RISER SWING-AWAY PIVOT TEARDROP LATERAL - LEFT

LEFT
DSALLRPKLTSMML
DSALLRPKLTMED
DSALLRPKLTLGE
RIGHT
DSALLRPKRTSMML
DSALLRPKRTMED
DSALLRPKRTLGE

## SWING AWAY CLAMP ON STRIGHT LATERAL



CLAMP-ON SWING-AWAY STRAIGHT LATERAL - LEFT

LEFT
DSALCLLSXSML
DSALCLLSSML
DSALCLLSMED
DSALCLLSLGE
RIGHT
DSALCLRXSML
DSALCLRSSML
DSALCLRSMED
DSALCLRSLGE

## SWING AWAY CLAMP ON CURVED LATERAL



CLAMP-ON SWING-AWAY CURVED LATERAL - LEFT

LEFT
DSALCLLCXSML
DSALCLLCSML
DSALCLLCMED
DSALCLLCLGE
RIGHT
DSALCLRCSXSMML
DSALCLRCSMML
DSALCLRCSMED
DSALCLRCLGE

## SWING AWAY CLAMP ON ANTERIOR LATERAL



CLAMP-ON SWING-AWAY ANTERIOR LATERAL - LEFT

LEFT
DSALCLLAXSML
DSALCLLASML
DSALCLLAMED
DSALCLLALGE
RIGHT
DSALCLRAXSML
DSALCLRASML
DSALCLRAMED
DSALCLRALGE

## SWING AWAY CLAMP ON TEARDROP LATERAL



CLAMP-ON SWING-AWAY TEARDROP LATERAL - LEFT

LEFT
DSALCLLTSMML
DSALCLLTMED
DSALCLLTLGE
RIGHT
DSALCLRSTSML
DSALCLRSTMED
DSALCLRRTLGE

## SWING AWAY CLAMP ON PIVOT STRAIGHT LAT



CLAMP-ON SWING-AWAY PIVOT STRAIGHT LATERAL - LEFT

LEFT
DSALCPLSXSMML
DSALCPLSSMML
DSALCPLSMED
DSALCPLSLGE
RIGHT
DSALCPRSXSML
DSALCPRSSMML
DSALCPRSMED
DSALCPRSLGE

## SWING AWAY CLAMP ON PIVOT CURVED LAT



CLAMP-ON SWING-AWAY PIVOT CURVED LATERAL - LEFT

LEFT
DSALCPLCXSMML
DSALCPLCSMML
DSALCPLCMED
DSALCPLCLGE
RIGHT
DSALCPRCSXSMML
DSALCPRCSMML
DSALCPRCSMED
DSALCPRCLGE



# THORACIC LATERALS

## SWING AWAY CLAMP ON PIVOT ANTERIOR LAT

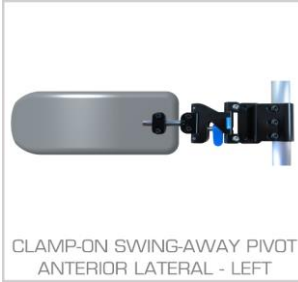

LEFT
DSALCPLAXSML
DSALCPLASML
DSALCPLAMED
DSALCPLALGE
RIGHT
DSALCPRXSML
DSALCPRASML
DSALCPRAMED
DSALCPRALGE

## SWING AWAY CLAMP ON PIVOT TEARDROP LAT



LEFT
DSALCPLTSML
DSALCPLTMED
DSALCPLTLGE
RIGHT
DSALCPRTSML
DSALCPRTMED
DSALCPRTLGE

## FIXED LATERAL BKT



DFL
-----

## FIXED ADJUSTABLE LATERAL BKT



DFLA
------

## LO RISER SWING AWAY LATERAL L-BKT



LEFT
DLRLB
RIGHT
DLRRB

## SWING AWAY LATERAL BKT

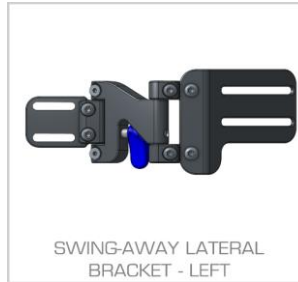

LEFT
DSALL
RIGHT
DSALR

## SWING AWAY CLAMP ON LATERAL BKT



LEFT
DSALCLL
RIGHT
DSALCLR

## SWING AWAY CLAMP ON PIVOT LATERAL BKT



LEFT
DSALCPL
RIGHT
DSALCPR

## SWING AWAY CLAMP ON L-BKT



DSALCLB
---------

## LO RISER SWING AWAY LATERAL BKT

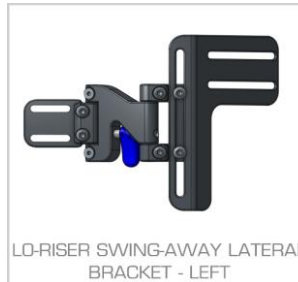

LEFT
DSALLRL
RIGHT
DSALLRR

# THORACIC LATERALS

## LO RISER SWING AWAY KIDS LATERAL BKT



LEFT
DSALLRKL
RIGHT
DSALLRKR

LO-RISER SWING-AWAY LATERAL KIDS BRACKET - LEFT

## SWING AWAY PIVOT LATERAL BKT



LEFT
DSALPL
RIGHT
DSALPR

SWING-AWAY PIVOT LATERAL BRACKET - LEFT

## LO RISER SWING AWAY PIVOT LATERAL BKT



LEFT
DSALLRPL
RIGHT
DSALLRPR

LO-RISER SWING-AWAY PIVOT LATERAL BRACKET - LEFT

## LO RISER SWING AWAY PIVOT KIDS LAT BKT



LEFT
DSALLRPKL
RIGHT
DSALLRPKR

LO-RISER SWING-AWAY PIVOT LATERAL WITH ANTERIOR PAD - LEFT

## LATERAL BKT MOUNT KIT



DLFKIT

## STD LAT PAD FSTNRS



DLPFKIT

## PIVOT LAT PAD FSTNRS



DLPPFKIT

## STRAIGHT LATERAL PAD



DLPPXSML
DLPPSSML
DLPPSMED
DLPPSLGE

STRAIGHT LATERAL PAD

## CURVED LATERAL PAD



DLPPCXSMML
DLPPCSML
DLPPCMED
DLPPCLGE

CURVED LATERAL PAD

## ANTERIOR LATERAL PAD



DLPPAXSML
DLPPASML
DLPPAMED
DLPPALGE

ANTERIOR LATERAL PAD

## TEARDROP LATERAL PAD



DLPPTDSML
DLPPTDMED
DLPPTDLGE
DLPPCUSTXL

TEARDROP LATERAL PAD

# THORACIC LATERALS

## LATERAL SPARE OUTER COVER



SPARE LATERAL PAD COVERS		
ST / CV	ANTERIOR	TEARDROP
DLPSXSMLOC	DLPAXSMLOC	DLPTDSMLOC
DLPSSMLOC	DLPASMLOC	DLPTDMEDOC
DLPSMEDOC	DLPAMEDOC	DLPTDLGEOC
DLPSLGEOC	DLPALGEOC	

## LATERAL EXTENSION LINK



DSALEXTL

## LATERAL EXTENSION PLATE

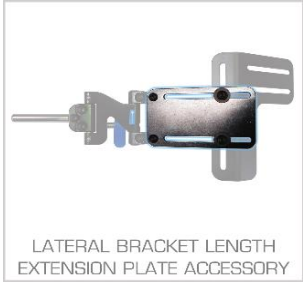

DSALEP

## LATERAL PIVOT LINK



DLPL

## CORPUS LATERAL INTERFACE BKT



CDSALLBKT

## LATERAL BKT BOOT KIT



DSALBOOT

## LATERAL GEL OVERLAY



DLPMODGO

## LATERAL CUSTOM CUT OUT

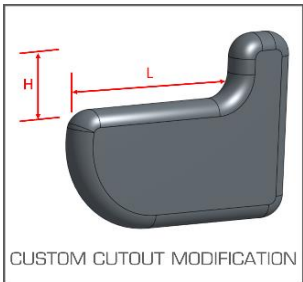

DLPMODC

## LATERAL DARTEX SMOOTH

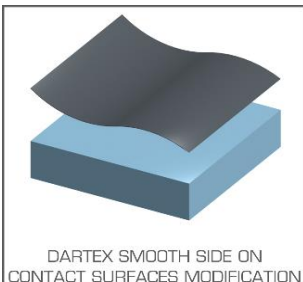

DLPMODCPU

## LATERAL CUSTOM FABRIC

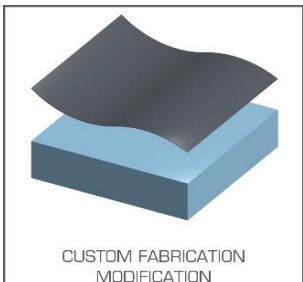

DLPMODCF

# HEADRESTS

## SQUARE AXIS HEADREST



DAHSQSML  
DAHSQLGE

## CONTOURED AXIS HEADREST



DAHCVXSML  
DAHCVSML  
DAHCVLGE

## OPEN CURVED AXIS HEADREST



DAHOC SML  
DAHOCLGE

## PIVOT WING AXIS HEADREST



DAHPWSML  
DAHPWLGE

## SQUARE AXIS SWING DOWN HEADREST



DAHSDSQSML  
DAHSDSQLGE

## CONTOURED AXIS SWING DOWN HEADREST



DAHSDCVXSML  
DAHSDCVSML  
DAHSDCVLGE

## OPEN CURVED AXIS SWING DOWN HEADREST



DAHSDOCSML  
DAHSDOCLGE

## PIVOT WING AXIS SWING DOWN HEADREST



DAHSDPWSML  
DAHSDPWLGE

## ASSIST HEADREST BKT



DASH

## AXIS HEADREST BKT



DAH

# HEADRESTS

## AXIS SWING DOWN HEADREST BKT



DAHSD

## CORPUS HEADREST INERFACE BKT



CDHIFB

## AXIS H/R PAD BALL

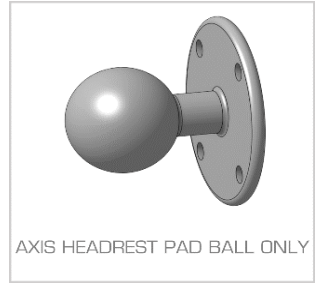

DAHPPB

## AXIS HEADREST MOUNT



DAHM

## AXIS SWING DOWN STEM



DAHSDVS

## AXIS HEADREST LINK

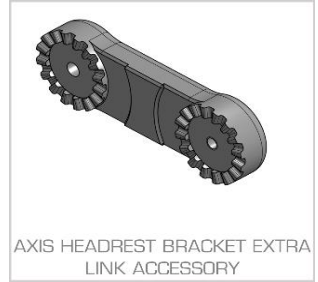

DAHLINK

## SQUARE PAD



DHPSQSML

DHPSQLGE

## CONTOURED PAD



DHPCXSML

DHPCSMML

DHPCLGE

## OPEN CURVED PAD



DHPOCSML

DHPOCLGE

## PIVOT WING PAD



DHPPWSML

DHPPWLGE

## HEADREST SPARE OUTER COVER



### HEADREST PAD SPARE OUTER COVER

SQUARE	CONTOURED	OPEN CURVED	PIVOT-WING
DHPSQSMLLOC	DHPCXSMLLOC	DHPOCSMLLOC	DHPPWSMLLOC
DHPSQLGEOC	DHPCSMLOC	DHPOCLGEOC	DHPPWLGEOC
	DHPCLGEOC		

## HEADREST SUNMATE OVERLAY

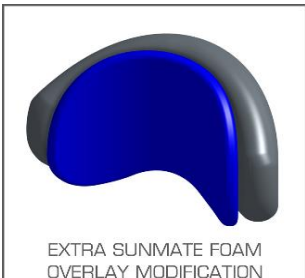

DHPMODSFO

## HEADREST DARTEX SMOOTH

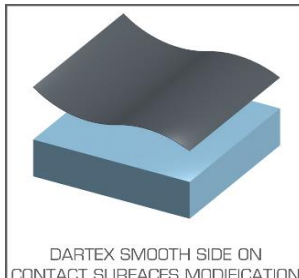

DHPMODCPU

## HEADREST CUT FABRIC

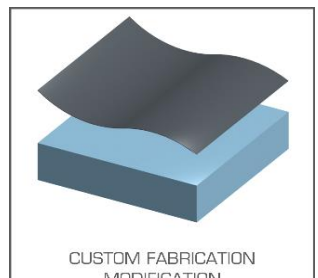

DHPMODCF

# HARNESSES

## H2X HARNESS



DH2XXSML
DH2XSML
DH2XMED
DH2XLGE
DH2XXLGE

## HARNESS PROTECTOR SLEEVES



DH2XPSXSML
DH2XPSSML
DH2XPSMED
DH2XPSLGE
DH2XPSXLGE

## HARNESS PROTECTOR SLEEVES DARTEX SMOOTH

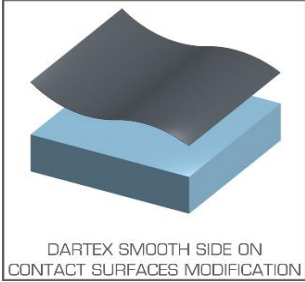

DH2XPSMODPU
-------------

## HARNESS RETAINER KIT



DHRK
------

## HARNRESS RETAINER CONNECTOR BKT



DHRCB
-------

## HARNESS RETAINER BKTS



DHRB
------

## TRI-BAR ADJUSTER 38mm



DTBA25
--------

## TRI BAR ADJUSTER 38mm



DTBA38
--------

## TRIANGLE MOUNT 25mm



DTRIMOUNT25
-------------

## TRIANGLE MOUNT 38mm



DTRIMOUNT38
-------------



# PADDED HIP BELTS

## 2-POINT CENTRE PULL SIDE RELEASE



DHB2CPXSML	DHB2CPSML
DHB2CPMED	DHB2CPLGE

## 2-POINT CENTRE PULL CENTRE RELEASE



DHB2CMSML	DHB2CMMED
DHB2CMLGE	

## 2-POINT DUAL CENTRE PULL



DHB2DPXSML	DHB2DPSML
DHB2DPMED	DHB2DPLGE

## 4-POINT CENTRE PULL SIDE RELEASE



DHB4CPXSML	DHB4CPSML
DHB4CPMED	DHB4CPLGE

## 4-POINT CENTRE PULL CENTRE RELEASE



DHB4CMSML	DHB4CMMED
DHB4CMLGE	

## 4-POINT DUAL CENTRE PULL



DHB4DPXSML	DHB4DPSML
DHB4DPMED	DHB4DPLGE

## 4-POINT REAR PULL SIDE RELEASE



DHB4RPSML	DHB4RPMED
DHB4RPLGE	

## 4-POINT REAR PULL REAR CENTRE RELEASE



DHB4RMSML	DHB4RMMED
DHB4RMLGE	

## HIP BLT GEL SLEEVES



DHBGELSLVSML	DHBGELSLVMED
DHBGELSLVLGE	

# PADDED CALF STRAPS

## PADDED CALF STRAPS



DPCS12
DPCS14
DPCS16
DPCS18
DPCS20
DPCSCUST

## CALF STRAP BUCKLE FASTENED MOD



DPCSMODBK
-----------

# FASTENERS

## BUTTON HEX SCREW



M6x10	DFASBHM610SPK20
-------	-----------------

## BUTTON HEX SCREW



M6x12	DFASBHM612BPK20
M6x16	DFASBHM616BPK20
M6x20	DFASBHM620BPK20
M6x25	DFASBHM625BPK20
M6x30	DFASBHM630BPK20
M6x40	DFASBHM640BPK20

## CAP SCREW



M5x12	DFASCSM512SPK20
-------	-----------------

## CAP SCREW



M5x20	DFASCSM520BPK20
M6x25	DFASCSM625BPK20
M6x30	DFASCSM630BPK20
M6x35	DFASCSM635BPK20

# FASTENERS

## COACH BOLT



M6x16	DFASCBM616BPK20
M6x20	DFASCBM620BPK20
M6x25	DFASCBM625BPK20
M6x30	DFASCBM630BPK20
M6x50	DFASCBM650BPK20
M6x60	DFASCBM660BPK20

## COUNTERSUNK SOCKET SCREW



M6x10	DFASCHSM610BPK20
M6x16	DFASCHSM616BPK20
M6x25	DFASCHSM625BPK20

## FIXING PLATE - 2 HOLE



DFASFXP2HOLBPK20

## FIXING PLATE - 3 HOLE



DFASFXP3HOLBPK20

## M5 NYLOC NUT



DFASNNM5BPK20

## M6 NYLOC NUT



DFASNNM6BPK20

## LARGE ALU WASHER



DFASAWM625PK20

## M6x12 FLAT WASHER



DFASWFM612BPK20

## M6x18 FLAT WASHER



DFASWFM618BPK20

## M6 SPRING WASHER



DFASWSM6BPK20

## COACH NUT



DFASCNM6



**ROLAPAL**

[www.rolapal.co.nz](http://www.rolapal.co.nz)  
[info@rolapal.co.nz](mailto:info@rolapal.co.nz)

Ph: + 64 9 634 2300